

Driving aggregate

Hydraulic polyp grab MPD is used for **drawing of impurities from pulper chest**. Equipment is designed for crane suspension. Its maximum carrying capacity is one ton. It can be suspended on a crane hook by shackle. Its electric motor supply voltage is 400 V/7,5 kW.

The hydraulic polyp grab is intended for taking tangles of impurities from the pulper chest bottom. Its driving aggregate is installed separately. The aggregate is suspended on a crane travelling carriage, which is mechanically coupled to the crane travel. The grab is interconnected with its driving aggregate by means of hydraulic hoses wound on a drum. This equipment is not allowed to be used in spaces with potential explosion hazards.

GRAB

Grab consists of four jaws separately controlled by hydraulic rolls. Its bearing part comprises closed welded framing. The top grab part is provided with a hinge to be suspended on the crane hook. Four jaws are pivoted on the frame, controlled by hydraulic cylinders attached to the frame. Inside the frame there is a distributor block providing hydraulic interconnection with all rolls through hoses. The grab is coupled to hydraulic hoses by means of a hydraulic lock and two quick-couplers providing quick uncoupling of the equipment from hydraulic hoses and its removal from the crane hook.

DRIVING AGGREGATE

The grab is driven by an electric motor (380 V; 7,5 kW) through a hydraulic aggregate. This aggregate comprises also an oil tank. On the oil tank top cover there is an electric motor linked to a gear pump and a distributor block with its filter. The aggregate is hinged on the own crane carriage with its drive. Pressure oil from the aggregate is led to the grab through hydraulic hoses wound on a drum according to an actual grab stroke.

ELECTRIC INSTALLATION

The grab is controlled by a hanging control board while the

operator is standing on the ground. This control includes turning the hydraulic aggregate on and off, opening and closing the grab jaws. In addition to that, there are warning lamps indicating stand-by mode, oil level and oil filter condition. Grab lifting, lowering and travelling can be controlled through the crane control board.

Machine design and work safety are in compliance with EU standards.



- possibility of using for diverse reject sorts handling
- simple maintenance and servicing
- easy operation and high work safety
- fast grab removal from crane hook

Advantages

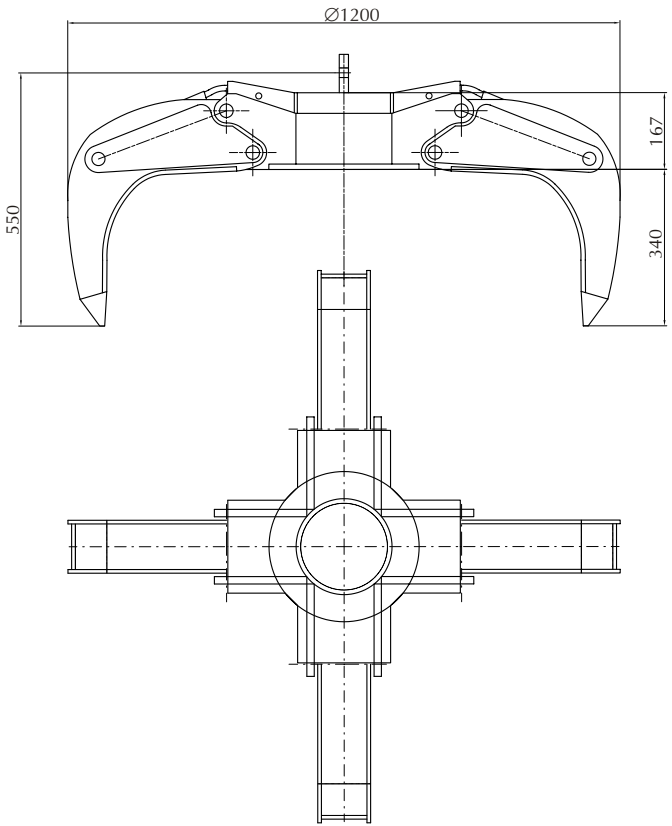
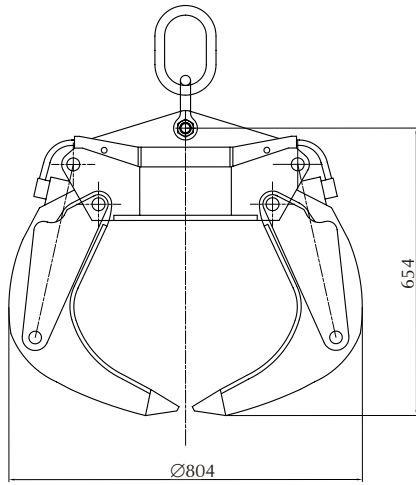

TECHNICAL PARAMETERS

Max. carrying capacity	t	1
Power supply	V	400
Installed el. motor output	kW	7,5
Jaws opening time	s	5,6
Jaws closing time	s	9,2
Rate of protection		IP54
Total weight	kg	2500

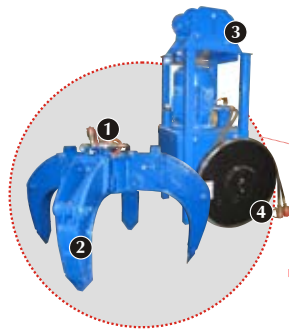

Main parts

- bearing part for crane suspension (1)
- steel jaws (2)
- hydroaggregate with electric motor (3)
- self-winding drum of hydroaggregate (connecting hoses to grab) (4)

Material

- structural steel St 52, protected against corrosion with high-quality polyurethane coating

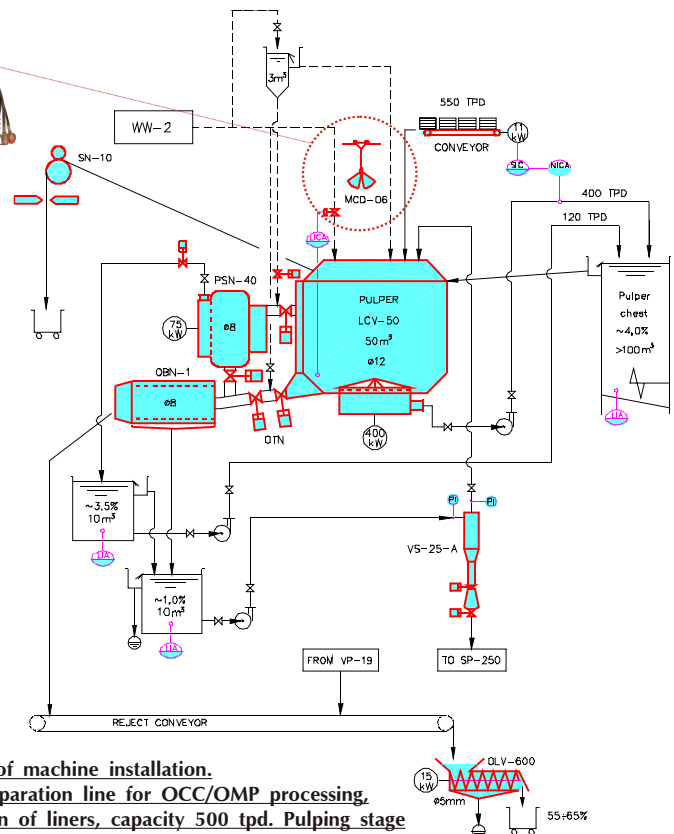

Example of machine installation.
Stock preparation line for OCC/OMP processing.
production of liners, capacity 500 tpd. Pulping stage